

## Products

Soldering iron/Built-in solder feed type

**HAKKO** **FX-8803** **ESD SAFE**  
ESD SAFE



One-hand manual-solder-feed iron designed exclusively for HAKKO FX-888D, FX-889, FR-701 and FR-702  
Manual system allows solder to be fed only when needed

[> Contact Us](#)

[> Catalog](#)

[> Manuals / SDS / Engineering documents](#)

Available in:

[Japan](#) [North America](#) [EU](#)

[Oceania](#) [Asia](#) [Other Countries](#)

[Features](#)

[Packing List / Specifications](#)

[Soldering Tip / Nozzle](#)

[Replacement Parts / Option](#)

[Maintenance](#)

### Soldering Tip / Nozzle

**T18 Series(for Solder feed)**

**Shape BC/C**

[How to use the BC/C and examples](#)

[Difference between BC/C and BCF/CF tip shape](#)

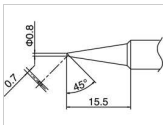

T18-C08 Shape-0.8C

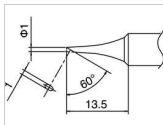

T18-C1 Shape-1C

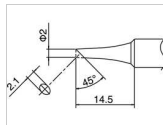

T18-C2 Shape-2C

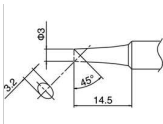

T18-C3 Shape-3C

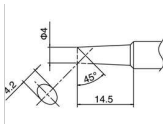

T18-C4 Shape-4C

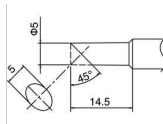

T18-C5 Shape-5C

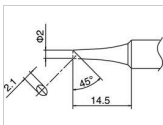

T18-CF2 Shape-2C

Tinned cut surface only

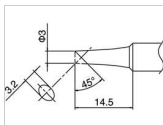

T18-CF3 Shape-3C

Tinned cut surface only

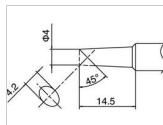

T18-CF4 Shape-4C

Tinned cut surface only

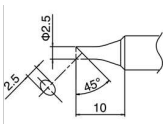

T18-CSF25 Shape-2.5CS

This type has good heat transfer with short tip end design, tinned cut surface only.

## Shape B

[How to use the B and examples](#)

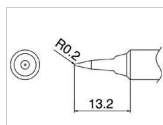
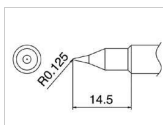
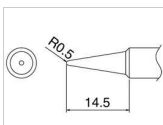

## Shape B Shape-B

[How to use the D and examples](#)

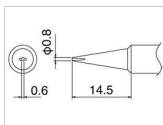

T18-D08 Shape-0.8D

## T18-S4 Shape-S4

Narrow-pitch Soldering Type (Shape S)

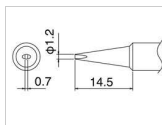

T18-D12 Shape-1.2D

## T18-SB Shape-SB

Narrow-pitch Soldering Type (Shape S)

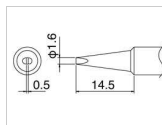

T18-D16 Shape-1.6D

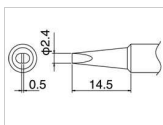

T18-D24 Shape-2.4D

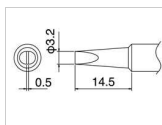

T18-D32 Shape-3.2D

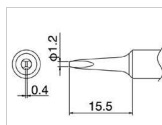

T18-S9 Shape-S9

## Shape I

[How to use the I and examples](#)

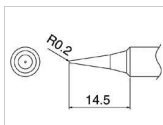

T18-I Shape-I

## Shape K

[How to use the K and examples](#)

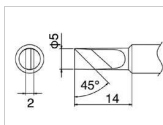

T18-K Shape-K