

NEW
Rotating-Type Escaper

Neji Taro HSV Series

The rotating-type escaper feeds the screws after separating the aligned screws one by one.

This avoids redundancy of screws and achieves stable chucking.

Feeds the screws faster and more reliably!

For Manual type

HSV Series (8 Models in Total)



- Can smoothly chuck unstable screws such as countersunk screws, screws with washers, and thin-head screws, and is also the most suitable for suction.
- The screw outlet doesn't vibrate and prevents mis-catch of screws.

NEW

Rotating-Type Escaper

As the aligned screws are not extruded, each screw can be picked up reliably.

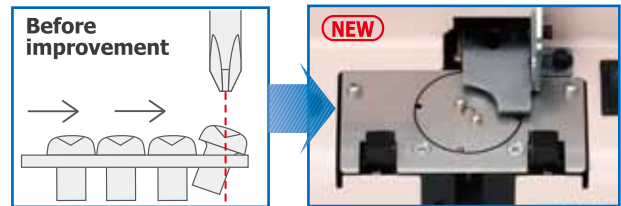

For Automatic Assembly type

HSV-RB Series (8 Models in Total)

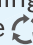
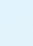

- The screw feeding operations have been changed to rotating type  from reciprocating type , thus increasing the feeding speed for the next screw by shortening the returning operations.
- The escaper rotates slowly, eliminating screw jump-out because of vibration.

For Manual type

HSV Series (8 Models in Total)

HSV-10 (M1.0) HSV-20 (M2.0)
 HSV-12 (M1.2) HSV-23 (M2.3)
 HSV-14 (M1.4) HSV-26 (M2.6)
 HSV-17 (M1.7) HSV-30 (M3.0)



For Automatic Assembly type

HSV-RB Series (8 Models in Total)

HSV-10RB (M1.0) HSV-20RB (M2.0)
 HSV-12RB (M1.2) HSV-23RB (M2.3)
 HSV-14RB (M1.4) HSV-26RB (M2.6)
 HSV-17RB (M1.7) HSV-30RB (M3.0)



Body specifications

Model		HSV
Power (AC Adapter)	Power input	AC100V-240V (50/60Hz)
	Power output	DC15V 1A
Dimensions (mm)		123(W)×181(D)×145(H)
Weight (kg)		Approximately 3kg
Screw capacity		80CC
Accessories		
1 AC adapter, 2 passage plates (with 1 plate pre-installed in the machine body) 1 hexagonal wrench, 1 driver (for timer adjustment)		

Body specifications

Model		HSV-RB
Power (AC Adapter)	Power input	AC100V-240V (50/60Hz)
	Power output	DC15V 1A
Dimensions (mm)		123(W)×181(D)×145(H)
Weight (kg)		Approximately 3kg
Screw capacity		80CC
Accessories		
1 AC adapter, 2 passage plates (with 1 plate pre-installed in the machine body) 1 hexagonal wrench, 1 driver (for timer adjustment) 2 escaper guides for robot (with 1 guide pre-installed in the machine body)		

Screw specifications

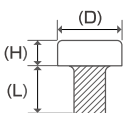

Head types that can be tightened

HSV-10~HSV-17	Type I/type III/flat*
HSV-20~HSV-30	Pan head (sems/W sems/washer head bind/flat*/truss/with a hex seat)

*Some flat screws cannot be used with this product depending on the diameter and thickness of the head. Please consult us for details.

Model	Nominal diameter	(D) Head diameter (φ)	(H) Head thickness (mm)	(L) Shaft length (mm)	Rail model
HSV-10	M1.0	1.2-9	0.35mm or more	1.6-10	HSV-BI-10
HSV-12	M1.2	1.4-9		1.8-10	HSV-BI-12
HSV-14	M1.4	1.6-9		2.0-10	HSV-BI-14
HSV-17	M1.7	1.9-9		2.3-10	HSV-BI-17
HSV-20	M2.0	2.2-9		2.6-20	HSV-BI-20
HSV-23	M2.3	2.5-9		2.9-20	HSV-BI-23
HSV-26	M2.6	2.8-9		3.2-20	HSV-BI-26
HSV-30	M3.0	3.2-9		3.6-20	HSV-BI-30

Screw specifications

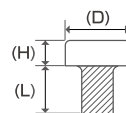

Head types that can be tightened

HSV-10RB~HSV-17RB	Type I/type III/flat*
HSV-20RB~HSV-30RB	Pan head (sems/W sems/washer head bind/flat*/truss/with a hex seat)

*Some flat screws cannot be used with this product depending on the diameter and thickness of the head. Please consult us for details.

Model	Nominal diameter	(D) Head diameter (φ)	(H) Head thickness (mm)	(L) Shaft length (mm)	Rail model
HSV-10RB	M1.0	1.2-9	0.35mm or more	1.6-10	HSV-RI-10
HSV-12RB	M1.2	1.4-9		1.8-10	HSV-RI-12
HSV-14RB	M1.4	1.6-9		2.0-10	HSV-RI-14
HSV-17RB	M1.7	1.9-9		2.3-10	HSV-RI-17
HSV-20RB	M2.0	2.2-9		2.6-20	HSV-RI-20
HSV-23RB	M2.3	2.5-9		2.9-20	HSV-RI-23
HSV-26RB	M2.6	2.8-9		3.2-20	HSV-RI-26
HSV-30RB	M3.0	3.2-9		3.6-20	HSV-RI-30

How to order

Plug Select

Voltage	100-120V	220V	220-230V
Plug Type	A	A with CCC	C
Code	E	CN	EUHK

Please refer to following example

No. of Screw size **Select Plug type**

HSV-30-CN → Ex.) HSV-30 with AC adaptor plug type A (CCC)

HSV-30RB-EUHK → Ex.) HSV-30RB with AC adaptor plug type C

HIOS INC.,
 111-6, Akiyama, Matsudo City Chiba Pref., JAPAN
 TEL: 81(JAPAN) 47-392-2090
 FAX: 81(JAPAN) 47-392-7773 www.hios.com

● Specifications and design are subject to change without notice. ● Catalog details current as of January, 2012.

